



Redmayne Arnold & Harris
estate agents, letting agents & surveyors

rah.co.uk



TO LET



3 West Field, Abington, Cambridge, CB21 6BE

£2,500 PCM

THE PROPERTY

This beautifully renovated home has been finished to a high standard throughout, offering generous and versatile living space ideal for modern family life. The property opens into a welcoming hallway with a convenient downstairs toilet, leading through to a spacious kitchen and dining area that is perfect for entertaining. A separate utility room provides additional practicality, complete with a side door offering direct access to the driveway. The ground floor also features a cosy snug and a well-appointed bedroom with French doors opening onto the garden, along with its own ensuite shower room.

Upstairs, the property continues to impress with a principal bedroom benefiting from an ensuite, alongside three further bedrooms, two of which include built-in storage. A contemporary family bathroom serves the remaining bedrooms. Externally, the home offers a tandem driveway comfortably accommodating two vehicles, as well as a garage suitable for additional parking or storage. To the rear, the garden provides a peaceful outdoor space with a large patio area, lawn, and surrounding greenery.

Situated in the sought-after village of Little Abington, the property benefits from a charming rural setting while remaining well connected. Excellent transport links include easy access to the A11, providing routes towards Cambridge and London, while nearby Great Chesterford and Whittlesford Parkway stations offer regular rail services into London Liverpool Street and Cambridge. The village itself offers a range of local amenities including a pub, village hall, and green spaces, with further shopping, dining, and leisure facilities available in nearby Cambridge.

The property is offered unfurnished and is professionally managed by Redmayne Arnold & Harris.

EPC Rating: C

Council Tax Band: E

Deposit: £2880

Holding Deposit: £390

SITUATION

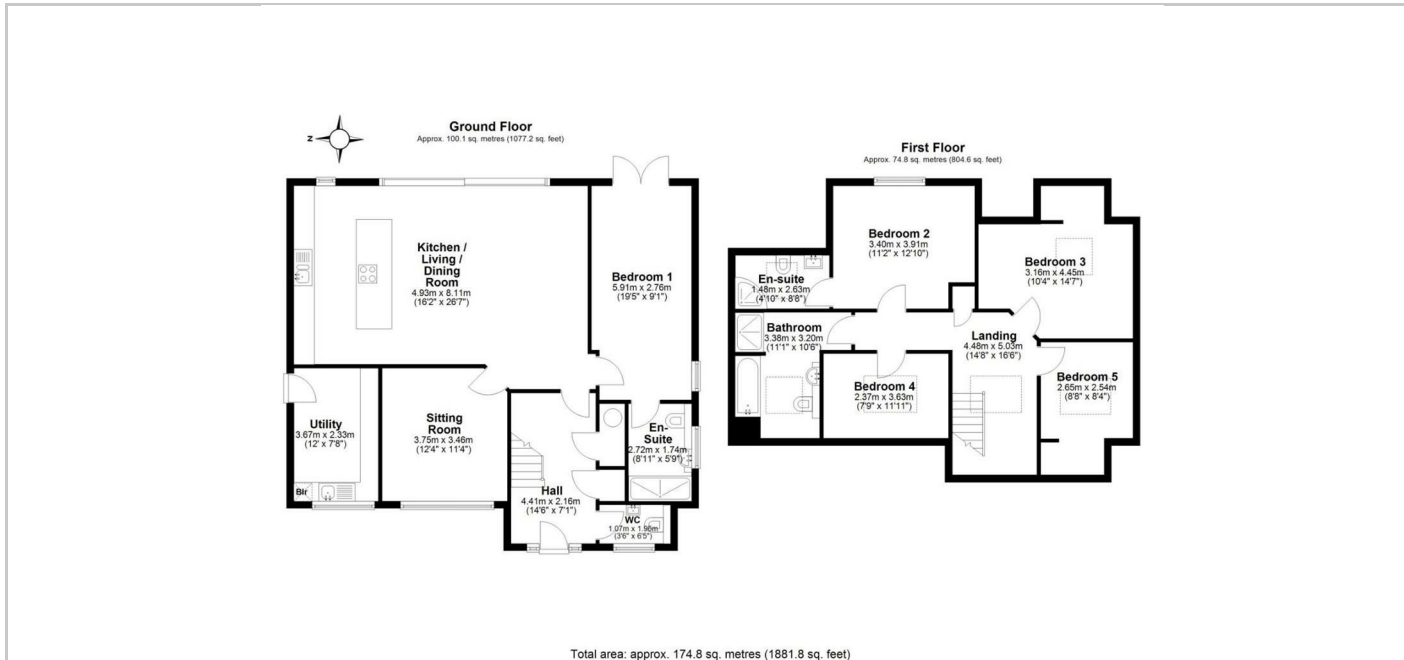

Directions

